

Na Závřiší

Čakov

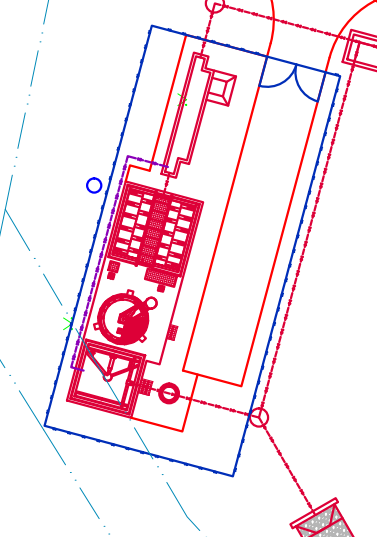

SO 01-Kanal. stoka A PVC, DN 400, dl.382,4m

SO 03-Kanal. stoka A-2, PVC, DN 400, dl.132,3m

SO 04-Kanal. stoka A-3, PVC, DN 300, dl.130,3m

SO 14-Kanal. stoka C-4, PVC, DN 300, dl.70,7m

SO 05-Kanal. stoka A-4, PVC, DN 400, dl.54,3m

SO 12-Kanal. stoka C-1, PVC, DN 300, dl.205,1 m

SO 17-Kanal. vyltak, DN 80, dl.307,3 m

SO 11-Kanal. stoka C-PVC, DN 400 dl.281,9m, DN 200 dl.3m

SO 13-Kanal. stoka C-2, PVC, DN 400, dl.113,7m

